

Pos	Krundi adressi nime ettepanek	Maakasutuse sihtotstarve (sõnadega)	Krundi pindala m <sup>2</sup>	Krundi adressi nime ettepanek	Maakasutuse sihtotstarve (sõnadega)	Krundi pindala m <sup>2</sup>
1	Pihlaka tee 14	Elamumaa-E-001-100%	2500	Tiidreku tee 1	Elamumaa-E-001-100%	2501
2	Pihlaka tee 16	Elamumaa-E-001-100%	2500	Tiidreku tee 2	Elamumaa-E-001-100%	2514
3	Pihlaka tee 17	Elamumaa-E-001-100%	2327	Tiidreku tee 4	Elamumaa-E-001-100%	2511
4	Pihlaka tee 15	Elamumaa-E-001-100%	2328	Tiidreku tee 6	Elamumaa-E-001-100%	2509
5	Pihlaka tee 13	Elamumaa-E-001-100%	2327	Tiidreku tee 8	Elamumaa-E-001-100%	2528
6	Pihlaka tee 11	Elamumaa-E-001-100%	2328	Tiidreku tee 10	Elamumaa-E-001-100%	2578
7	Pihlaka tee 9	Elamumaa-E-001-100%	2500	Tiidreku põik 2	Elamumaa-E-001-100%	3191
8	Pihlaka tee 7	Elamumaa-E-001-100%	2501	Tiidreku tee 11	Elamumaa-E-001-100%	3278
9	Pihlaka tee 5	Elamumaa-E-001-100%	2501	Tiidreku tee 12	Elamumaa-E-001-100%	2665
10	Pihlaka tee 3	Elamumaa-E-001-100%	2501	Tiidreku tee 14	Elamumaa-E-001-100%	2986
11	Pihlaka tee 1	Elamumaa-E-001-100%	2500	Tiidreku tee 16	Elamumaa-E-001-100%	2506
12	Pihlaka tee 2	Elamumaa-E-001-100%	2652	Tiidreku tee 18	Elamumaa-E-001-100%	2501
13	Pihlaka tee 4	Elamumaa-E-001-100%	2656	Tiidreku tee 21	Elamumaa-E-001-100%	2503
14	Pihlaka tee 6	Elamumaa-E-001-100%	2656	Tiidreku tee19	Elamumaa-E-001-100%	2500
15	Pihlaka tee 8	Elamumaa-E-001-100%	2530	Tiidreku tee 17	Elamumaa-E-001-100%	2504
16	Pihlaka tee 10	Elamumaa-E-001-100%	3305	Tiidreku tee 15	Elamumaa-E-001-100%	2503
17	Pihlaka tee 12	Elamumaa-E-001-100%	2978	Tiidreku tee 13	Elamumaa-E-001-100%	2519
18	Tiidreku põik 4	Elamumaa-E-001-100%	3088	Tiidreku tee	Transpordimaa-L-007-100%	9572
19	Tiidreku tee 9	Elamumaa-E-001-100%	2615	Tiidreku põik	Transpordimaa-L-007-100%	1773
20	Tiidreku tee 7	Elamumaa-E-001-100%	2502	Pihlaka tee	Transpordimaa-L-007-100%	7533
21	Tiidreku tee 5	Elamumaa-E-001-100%	2506	Pihlaka põik	Transpordimaa-L-007-100%	693
22	Tiidreku tee 3	Elamumaa-E-001-100%	2500	Suvilate tee 2	Transpordimaa-L-007-100%	1177
45	Tiidreku	Üldkasutatav maa-üm-017-100%	4263			

Planeeritavad uued piirpunktid

Pos	X-koordinaat	Y-koordinaat	Pos	X-koordinaat	Y-koordinaat
1	X=6454608.587	Y=402536.811	32	X=6454746.979	Y=402988.600
2	X=6454545.438	Y=402484.642	33	X=6454730.024	Y=402934.294
3	X=6454564.908	Y=402545.446	34	X=6454765.383	Y=402923.638
4	X=6454565.833	Y=402550.123	35	X=6454747.492	Y=402856.713
5	X=6454535.785	Y=402557.611	36	X=6454709.389	Y=402868.196
6	X=6454608.685	Y=402581.821	37	X=6454690.140	Y=402906.541
7	X=6454550.327	Y=402590.104	38	X=6454700.789	Y=402794.296
8	X=6454601.466	Y=402555.939	39	X=6454728.957	Y=402795.450
9	X=6454594.717	Y=402551.785	40	X=6454716.127	Y=402754.998
10	X=6454567.235	Y=402557.218	41	X=6454714.761	Y=402749.899
11	X=6454618.228	Y=402616.015	42	X=6454678.464	Y=402732.385
12	X=6454616.179	Y=402619.825	43	X=6454669.425	Y=402740.186
13	X=6454564.503	Y=402636.493	44	X=6454701.100	Y=402729.983
14	X=6454568.611	Y=402647.777	45	X=6454660.057	Y=402710.181
15	X=6454619.705	Y=402631.261	46	X=6454649.423	Y=402676.119
16	X=6454623.454	Y=402633.202	47	X=6454630.976	Y=402617.029
17	X=6454635.113	Y=402670.548	48	X=6454727.245	Y=402674.141
18	X=6454582.843	Y=402686.867	49	X=6454722.718	Y=402695.314
19	X=6454648.018	Y=402711.896	50	X=6454745.026	Y=402751.466
20	X=6454597.674	Y=402727.603	51	X=6454726.056	Y=402773.866
21	X=6454614.266	Y=402773.178	52	X=6454818.255	Y=402716.355
22	X=6454662.452	Y=402758.118	53	X=6454874.922	Y=402782.697
23	X=6454677.570	Y=402806.543	54	X=6454830.310	Y=402781.510
24	X=6454631.635	Y=402820.884	55	X=6454815.873	Y=402785.357
25	X=6454649.904	Y=402871.064	56	X=6454732.533	Y=402782.742
26	X=6454693.467	Y=402857.463	57	X=6454722.462	Y=402753.613
27	X=6454710.280	Y=402911.316	58	X=6454768.401	Y=402775.777
28	X=6454669.225	Y=402924.133	59	X=6454731.335	Y=402779.307
29	X=6454736.674	Y=402995.862	60	X=6454781.091	Y=402815.203
30	X=6454785.066	Y=402997.334	61	X=6454743.419	Y=402826.530
31	X=6454775.475	Y=403010.066	62	X=6454754.346	Y=402882.339
			63	X=6454796.243	Y=402970.510
			64	X=6454808.297	Y=402915.295
			65	X=6454796.717	Y=402918.442

Pos	X-koordinaat	Y-koordinaat	Pos	X-koordinaat	Y-koordinaat
66	X=6454812.493	Y=402930.734	96	X=6454835.229	Y=402792.618
67	X=6454800.914	Y=402933.882	97	X=6454892.963	Y=402761.483
68	X=6454770.339	Y=402942.192	98	X=6454890.343	Y=402757.022
69	X=6454827.400	Y=402985.814	99	X=6454889.682	Y=402735.804
70	X=6454845.384	Y=403051.739	100	X=6454904.571	Y=402712.600
71	X=6454840.104	Y=403058.749	101	X=6454908.490	Y=402710.339
72	X=6454832.884	Y=403068.334	102	X=6454951.922	Y=402718.837
73	X=6454864.776	Y=403077.333	103	X=6454949.618	Y=402730.613
74	X=6454871.634	Y=403082.499	104	X=6454941.925	Y=402769.934
75	X=6454879.620	Y=403069.767	105	X=6454941.109	Y=402774.106
76	X=6454883.636	Y=403062.860	106	X=6454947.400	Y=402781.790
77	X=6454888.389	Y=403052.766	107	X=6454965.321	Y=402733.685
78	X=6454891.263	Y=403040.960	108	X=6454967.625	Y=402721.909
79	X=6454894.035	Y=403028.723	109	X=6454994.631	Y=402727.193
80	X=6454896.083	Y=403011.136	110	X=6455025.193	Y=402734.765
81	X=6454899.475	Y=402997.843	111	X=6455017.061	Y=402767.587
82	X=6454847.115	Y=403012.355	112	X=6455054.594	Y=402742.049
83	X=6454903.636	Y=402991.540	113	X=6455087.936	Y=402763.387
84	X=6454834.630	Y=402956.074	114	X=6455073.929	Y=402794.576
85	X=6454835.517	Y=402969.886	115	X=6455139.563	Y=402770.943
86	X=6454820.238	Y=402913.476	116	X=6455105.574	Y=402759.385
87	X=6454867.850	Y=402927.480	117	X=6455109.438	Y=402748.024
88	X=6454860.382	Y=402914.570	118	X=6455125.928	Y=402699.531
89	X=6454854.005	Y=402904.007	119	X=6455070.723	Y=402692.100
90	X=6454862.830	Y=402841.940	120	X=6455057.974	Y=402730.523
91	X=6454860.665	Y=402838.464	121	X=6454997.227	Y=402715.473
92	X=6454803.937	Y=402835.502	122	X=6455004.127	Y=402675.518
93	X=6454792.061	Y=402809.811	123	X=6454952.927	Y=402654.744
94	X=6454795.958	Y=402803.083	124	X=6454943.117	Y=402670.886
95	X=6454832.553	Y=402793.331	125	X=6454894.547	Y=402695.383
			126	X=6454865.263	Y=403092.723

Tingmärgid.

- planeeritava ala piir
- olemasolevad kinnistute piirid
- planeeritavate krundi piirid
- planeeritavad uued piirpunktid
- planeeritav hoone (tinglik)
- k'vakattega tee
- ▲ juurdepääs
- kitsendus Ehitusseaduse §14 "Tehnõvõrgud ja rajatised"
- perspektiivne kitsendus AOS §156 "Juurdepääs avalikult kasutatavale teele"
- rooeevupmla kuja

Märkused.

- Planeering on koostatud OU Geosnap poolt teostatud geodeetilise alusplaanil alusel, töö nr DP-17, 2010.a.
- Seletuskiri kuulub lahutamatu osana detailplaneeringu jonnise juurde.

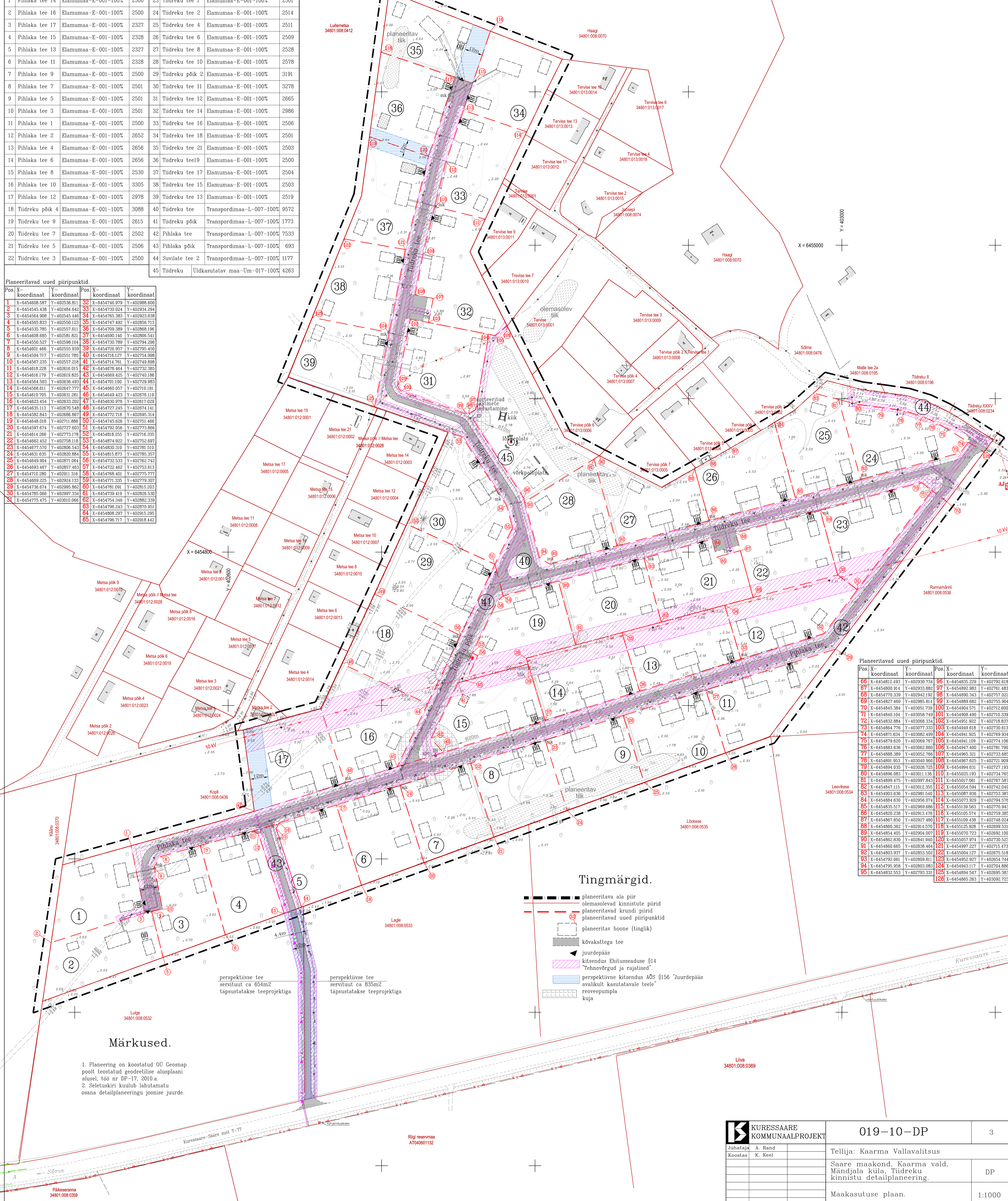

	019-10-DP		3
	Juhataja A. Rand Koostas K. Keel	Tellija: Kaarma Vallavalitsus Saare maakond, Kaarma vald, Mändjala küla, Tiidreku kinnistu detailplaneering.	
		Maakasutuse plaan.	1:1000