

KRUNTIDE ANDMED

Nr.	Krundi nimi	Krundi pindala	Krundi kasutuse sihtotstarve	Sihtotstarbe osakaal
1	Positsoon 1	4881 m ²	Elumumaa (E)	100 %
2	Positsoon 2	4881 m ²	Elumumaa (E)	100 %
3	Positsoon 3	4881 m ²	Elumumaa (E)	100 %
4	Positsoon 4	4899 m ²	Elumumaa (E)	100 %
5	Positsoon 5	4899 m ²	Elumumaa (E)	100 %
6	Positsoon 6	4899 m ²	Elumumaa (E)	100 %
7	Positsoon 7	7527 m ²	Elumumaa (E)	100 %
8	Positsoon 8	7527 m ²	Elumumaa (E)	100 %
9	Positsoon 9	7527 m ²	Elumumaa (E)	100 %
10	Positsoon 10	2496 m ²	Sotsiaalmaa (Ü), Tootlemaa (T)	90 % 10 %
11	Positsoon 11	3854 m ²	Transpordimaa (L)	100 %

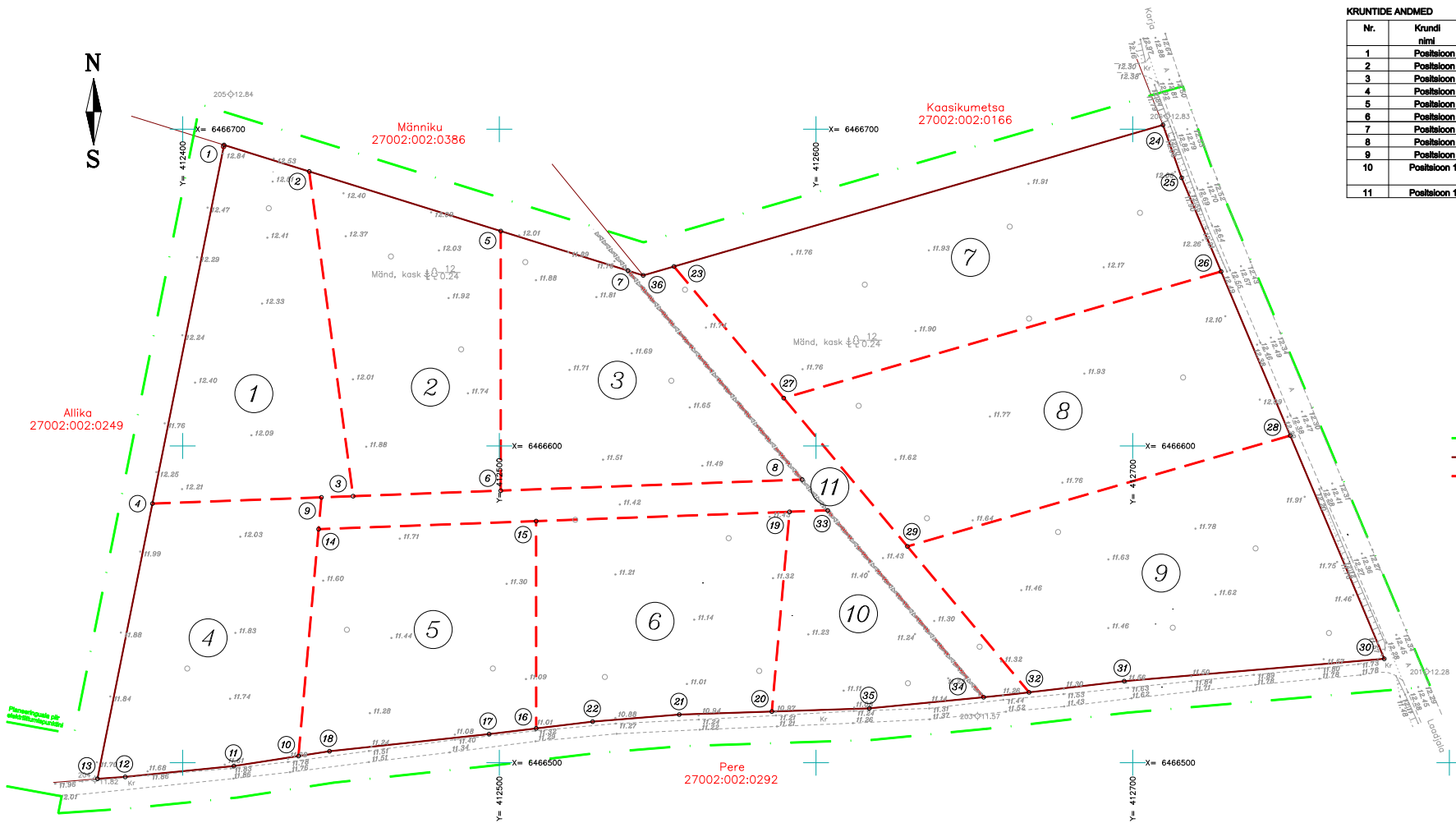

Tingmärgid

- Planeeringuala piir
- Olemasolev kinnistupiir
- Planeeritava krundipiir
- Pliitmärk
- Pliitpunkt number
- Krundi number

202-012.25

PIIRIPUNKTIDE TABEL

Punkti nr.	X	Y	Stee-nurgad	Joonis pikused
Positsoon 1				
1	6466995.02	412413.07	84°01'	28.16
2	6466986.66	412439.96	114°59'	103.44
3	6466584.14	412453.82	84°25'	53.41
4	6466581.80	412390.45	78°35'	115.46
1	6466995.02	412413.07		
Positsoon 2				
5	6466986.66	412439.96	65°01'	63.36
2	6466967.83	412500.45	107°17'	81.97
6	6466585.67	412500.45	92°07'	46.86
3	6466584.14	412453.82	95°35'	103.44
2	6466986.66	412439.96		
Positsoon 3				
5	6466967.83	412500.45	72°43'	42.07
7	6466555.34	412540.62	147°07'	85.87
8	6466589.39	412595.62	52°17'	95.24
6	6466585.67	412500.45	87°53'	81.97
5	6466967.83	412500.45		
Positsoon 4				
4	6466581.80	412390.45	103°25'	53.41
9	6466585.78	412443.82	82°48'	81.99
10	6466502.10	412436.57	103°52'	20.64
11	6466496.95	412416.17	178°56'	34.48
12	6466495.52	412381.86	178°12'	8.79
13	6466494.82	412373.09	74°47'	88.60
4	6466581.80	412390.45		

Punkti nr.	X	Y	Stee-nurgad	Joonis pikused
Positsoon 5				
14	6466573.74	412442.93	97°12'	68.73
15	6466576.27	412511.82	87°54'	65.45
16	6466510.83	412511.84	96°50'	14.98
17	6466509.04	412496.78	179°17'	50.68
18	6466503.82	412446.37	182°39'	9.92
10	6466502.10	412436.57	78°08'	71.91
14	6466573.74	412442.93		
Positsoon 6				
15	6466576.27	412511.82	92°08'	80.09
19	6466579.24	412591.65	82°48'	63.33
20	6466516.16	412596.04	96°57'	29.24
21	6466515.20	412556.82	182°48'	27.45
22	6466512.97	412529.46	182°11'	17.96
16	6466510.83	412511.84	83°10'	65.45
15	6466576.27	412511.82		
Positsoon 7				
23	6466656.65	412555.15	66°19'	160.74
24	6466701.34	412709.55	93°19'	49.77
25	6466684.65	412715.45	183°23'	32.09
26	6466655.06	412727.81	83°18'	143.78
27	6466615.10	412589.80	113°41'	54.10
23	6466656.65	412555.15		
Positsoon 8				
27	6466615.10	412589.80	66°19'	143.78
26	6466655.06	412727.81	96°42'	56.21
28	6466603.27	412749.74	83°17'	125.85
29	6466586.29	412628.85	113°42'	60.96
27	6466615.10	412589.80		

Punkti nr.	X	Y	Stee-nurgad	Joonis pikused
Positsoon 9				
29	6466568.29	412628.85	66°18'	125.85
28	6466903.27	412749.74	96°43'	76.46
30	6466532.61	412779.43	72°04'	82.41
31	6466525.75	412697.32	181°47'	30.26
32	6466522.22	412687.27	123°08'	59.99
29	6466568.29	412628.85		
Positsoon 10				
19	6466579.24	412591.65	97°12'	12.01
33	6466579.68	412603.65	127°45'	78.88
34	6466520.67	412652.93	55°41'	36.28
35	6466517.16	412616.82	178°19'	30.79
20	6466516.16	412586.04	83°03'	63.33
19	6466579.24	412591.65		
Positsoon 11				
7	6466555.34	412540.62	342°43'	5.03
36	6466553.44	412545.43	213°25'	10.12
23	6466565.65	412555.15	113°42'	175.05
32	6466522.22	412687.27	66°20'	14.42
34	6466520.67	412652.93	123°42'	78.88
33	6466579.68	412603.65	232°15'	160.83
14	6466573.74	412442.93	82°48'	10.08
9	6466583.78	412443.82	97°12'	151.90
8	6466589.39	412595.62	307°43'	85.87
7	6466555.34	412540.62		

Märkus: planeering on koostatud DP Projektbüroo OÜ taastatud geodeetilise alusega, t00 nr. 29-07-G, aluse; lähtepunktki on riikliku plaanilise võrgu geodeetiline punkt nr. 5251 Kuresaare67; koordinaadid on L-EST'97 süsteemis; kõrgused on BK'77 süsteemis; detailplaneeringu seletuskiri kuulub lahutamatu osana joonise juurde.

	DP Projektbüroo OÜ Reg.kood 11217547 Rohu 5, Kuresaare Tallinn 15105 alar@dpprojekt.ee	DETAILPLANEERING Tellija: Marek Aavik	T00 nr. 26-08-DP Joonis 3/4
	Koostaja: Tiina Kilker Allikiri:	SAARE MAAKOND, KAARMA VALD, VESTLA KÜLA, JALAKAMETSA KINNISTU	M001kava 1:1000
Kuupäev: 05.03.2009	Krundijaotusplan		